

STAND WEIGHT: 478 LBS
MATERIAL OF CONSTRUCTION: POWDER COATED STEEL

REVISIONS				
ZONE	REV.	DESCRIPTION	DATE	APPROVED

A

A

5/8" DIA X6" LONG WEDGE ANCHORS WITH
4" MINIMUM EMBEDMENT - 2 PER BASE
ANCHORS SUPPLIED BY OTHERS

41.625
40.737
36.987

SECTION A-A
SCALE 1 : 24

4.737
.987
0

0
1.125
7.125
23.500
29.500
44.125

25.000

78.500

61.250

61.250

B

B

C

C

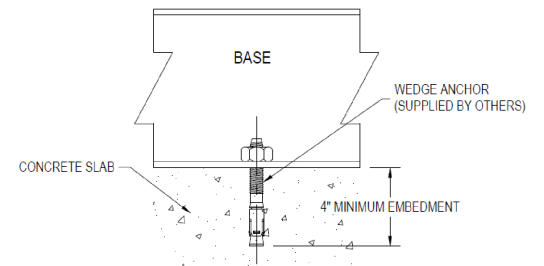

ANCHORING DETAIL

SCALE: 1/4

D

D

CONCRETE SLAB AND SOIL REQUIREMENTS (BASED ON WORST CASE SEISMIC ZONE IN LOWER 48 STATES)
5" THICK 2500 PSI SLAB; 750 PSF SOIL BARING PRESSURE AT GRADE

UNLESS OTHERWISE SPECIFIED: DIMENSIONS ARE IN INCHES TOLERANCES: FRACTIONAL: ±1/16 ANGULAR: MACH ±1° BEND ±1° TWO PLACE DECIMAL ±0.03 THREE PLACE DECIMAL ±0.031	CONTRACT NO.	COLMAC INDUSTRIES 401 N. Lincoln, Coville, Washington 99114 (509)884-4505	
	TITLE	SUBMITTAL RACKING STAND FOR CxV/CxA 5	
DRAWN BY ENGINEER CHECKED BY DATE	DATE DATE DATE	SIZE DWG. NO. A 1010170-0001	REV. -
NEXT ASSY APPLICATIONS USED ON APPLICATIONS REV. NO. REV STATUS SHT. NO. OF SHEET	SOLEWORKS AIRFOCAD DO NOT SCALE DRAWING	SCALE: 1:32 UNIT WT.	SHEET 1 OF 1

PROPRIETARY AND CONFIDENTIAL
THE INFORMATION CONTAINED IN THIS DRAWING IS THE SOLE PROPERTY OF COLMAC INDUSTRIES. ANY
REPRODUCTION IN PART OR AS A WHOLE WITHOUT THE WRITTEN PERMISSION OF COLMAC INDUSTRIES IS PROHIBITED.

5/11/2021

1010170-0001

5

4

3

2

1

5

4

3

2

1